



LEER[®]
Commercial Products



WE GO TO WORK WITH YOU.

DCC

LEER Deluxe Commercial Caps are constructed from durable, lightweight aluminum with options and configurations to fit any truck and worksite application.



**MORE TRUCKS ARE DRIVEN TO WORK
WITH RUGGED **LEER** COMMERCIAL CAPS THAN ANY OTHER BRAND!**

DCC



DCC





DCC

DCC STANDARDS & OPTIONS

Standard Features:

- ◆ **NEW** .035 Exterior Smooth Skin Aluminum Roof Metal
- ◆ **NEW** Full Length Side Doors with Gas Props
- ◆ **NEW** Stainless Steel Drop-T Handles and BOLT Locks with "One Key Technology"
- ◆ **NEW** DCC Fuse Box
- ◆ Interior Wire Loomed and Secured
- ◆ Solid ½ Rear Lift Door with Gas Props and Contoured Door Skirt
- ◆ Exterior Mounted LED Third Brake Light
- ◆ Heavy Duty Aluminum Base Rails
- ◆ TIG Welded "Super Cage" Integrated Roof Construction
- ◆ Solid Front Wall
- ◆ Black Trim
- ◆ LEER 5 Year Structural Warranty

Choice of Available Colors:

- ◆ **NEW** .035 YZ White
- ◆ .035 Polar White
- ◆ .035 Black
- ◆ .035 Dove Grey

Factory Installed Options

Automotive Paint:

- ◆ DuPont Base Coat/Clear Coat Automotive Paint
- ◆ Tri-Coat Automotive Paint

Height Options:

Compact Trucks – Cab Level by Request

- ◆ 23" ◆ **NEW** 26"
- ◆ 30" ◆ 36"

Full Size Trucks – Cab Level by Request

- ◆ 23" ◆ **NEW** 26" ◆ 30"
- ◆ 36" ◆ 40"

Ford Super Duty Trucks

- ◆ 26" ◆ 30"
- ◆ 36" ◆ 40"

Wedge Options – Available Heights

Low to High Indicated

- ◆ 23"- 26" Compact and Full Size
- ◆ 23"- 30" Compact and Full Size
- ◆ 23"- 36" Compact and Full Size



DCC



Full Length Solid Side Door



Bolt Lock with Stainless Steel Drop T-handle



.035 Exterior Smooth Skin Aluminum Roof Metal



TIG Welded Super Cage Roof Integrated Construction



Exterior Mounted LED Third Brake Light



Heavy Duty Aluminum Base Rails for Mounting with Interior Clamps

DCC



DCC with Full Length Side Door
and Single Full Door



DCC with Full Length Side Door
and Double Full Doors
with Radius Windows





Radius Front Picture Window (Optional)



Rear Radius Picture Window for 1/2 Door (Optional)



Window Security Screen (Optional)



Side Tool Box (Optional)



Side Tool Box with Skin (Optional)



Side Tool Box with Horizontal Shelf and Divider (Optional)



Side Tool Box 40" LED Lighting (Optional)



Bolt Plate Reinforcement for Aftermarket Rack System (Optional)



Three Shelf Storage Unit (Optional)



Gas Prop with 12 Volt Switch (Optional)



Prime Design™ Locking Ladder Rack

BEDSLIDE turns your truck bed into a sliding drawer providing easy, safe and secure access to gear, tools, supplies and equipment. BEDSLIDE can be adapted with custom boxes, racks or dividers and fits almost any truck or application.



DCC OPTIONS

Front Options:

- ◆ Solid Front Wall – Standard
- ◆ Rectangular Front Picture Window
- ◆ Radius Front Picture Window
- ◆ Rectangular Front Sliding Window
- ◆ Radius Front Sliding Window
- ◆ Window Security Screen
(Available for Rectangular Picture Windows Only)

Rear Options:

- ◆ **NEW** Solid 1/2 Read Door with Stainless Steel Drop T-Handle and Bolt Lock – Standard
- ◆ Rear Radius Picture Window for 1/2 Door
- ◆ **NEW** Double Full Doors Flush Mount with Stainless Drop T-Handle and BOLT Lock
- ◆ Two Long Radius Windows for Full Doors
- ◆ **NEW** Single Full Door Flush Mount with Stainless Drop T-Handle and BOLT Lock – Left Side Hinge
- ◆ Rear Radius Picture Window for Single Full Door

- ◆ **NEW** Hatchback Full Door Flush Mount with Stainless Drop T-Handle and BOLT Lock
- ◆ Rear Radius Picture Window for Hatchback Full Door
- ◆ Window Security Screen
- ◆ Metal Skin Interior of Rear 1/2 Door
- ◆ **NEW** Metal Skin Full Interior Height of Rear Double Doors
- ◆ **NEW** Metal Skin Full Interior Height of Single Full Door
- ◆ **NEW** Metal Skin Full Interior Height Hatchback Door
- ◆ Exterior Mounted LED Third Brake Light – Standard
- ◆ **NEW** BOLT Lock deduct to Strattec Automotive Lock Core

Side Door Options:

- ◆ Full Length Side Door Each Side with Stainless Steel Drop T-Handle and Bolt Lock – Standard
- ◆ **NEW** Delete Standard Side Door
- ◆ **NEW** Side Door Metal Skin Interior
- ◆ **NEW** Double 40" Side Doors with Stainless Steel Drop T-Handle and BOLT Lock (8' units only)

- ◆ Side Door 66" with Stainless Steel Drop T-Handle and Bolt Lock (8' units only)
- ◆ Side Door Windows
- ◆ Radius Side Window 72 x 14 or Smaller (Dark tint glass)
- ◆ Radius Side Sliding Window
- ◆ Window Security Screen
- ◆ **NEW** BOLT Lock deduct to Strattec Automotive Lock Core
- ◆ **NEW** Full Side Wall Metal Skin Interior

Tool Box Options:

- ◆ Tool Box 66" L x 16" H x 12" D
- ◆ Tool Box 82" L x 16" H x 12" D
- ◆ Rubberized Non-Slip Mat for Tool Box Floor
- ◆ Storage Solutions – Parts Bins and Shelf Bins

Tool Box Shelf/Divider Options:

- ◆ Includes Powder Coated (White) Metal Tool Box, Shelf, or Divider (See chart)

Interior Lighting /Power Options:

- ◆ **NEW** 12 Volt LED Light Bar – 20"
- ◆ **NEW** 12 Volt LED Light Bar – 40"

- ◆ 12V Dome Light Gas Prop Switch – Dome Light Purchase Required (Switch is available for all DCC doors)
- ◆ 12V Three Outlet Power Block
- ◆ **Interior LED Bar Light Options:**
- ◆ **NEW** Includes Lights and Wiring (Loomed in location as displayed to the standard fuse box) (See chart)

Interior Options:

- ◆ **NEW** Interior Headliner – Roof Sheet Only
- ◆ **NEW** Interior Headliner – Complete Unit Side Doors Excluded
- ◆ Metal Skin Interior Roof and Front Flat Surface Only (Rear door not included)
- ◆ Interior Roof Rack 5 1/2"D x 16"W Each
- ◆ Interior Roof Rack 8 1/2"D x 16"W Each

Exterior Rack Options:

- (Note: All DCC factory installations of Thule®, CapRac, and Prime Design™ require the boltplate reinforcement option)
- ◆ LEER DCC TIG Welded Aluminum Ladder Rack – Six Position Mounting

- ◆ **NEW** Prime Design™ – Single Clamping Ladder Rack
- ◆ **NEW** Prime Design™ – Double Clamping Ladder Rack
- ◆ **NEW** Prime Design™ – Step Ladder Option
- ◆ **NEW** Prime Design™ – Single Rotation Ladder Rack
- ◆ **NEW** Prime Design™ – Dual Rotation Ladder Rack
- ◆ **NEW** Beacon Light Mounting Bracket
- ◆ Thule® – Aeroblade II Roof Rack System with Locks
- ◆ Thule® – Tracker II Roof Rack System with Locks
- ◆ CapRac – Commercial Rack System (2-Bar Set with Load Stops)
- ◆ Boltplate Reinforcement for Aftermarket Rack Systems
- ◆ Kargo Master Pro III Cap Mount Rack System

BEDSLIDE:

- ◆ **NEW** BEDSLIDE GO
- ◆ BEDSLIDE 1000
- ◆ BEDSLIDE 1000 Pro SE
- ◆ BEDSLIDE 1500 Pro CG
- ◆ BEDSLIDE 2000 Pro HD

DCC ORDER FORM

Truck Year _____

Truck Brand _____

Truck Model _____

Cab Style

- ☐ Reg Cab ☐ Quad Cab – 4 Door
☐ Ext Cab ☐ Double Cab

Box Style

- ☐ Long Box ☐ Short Box
☐ Extra Short ☐ Flareside/Sportside/Stepside

Truck VIN _____

Truck Color Code _____

1. AVAILABLE COLORS: .035



- ☐ YZ White ☐ Polar White



- ☐ Dove Grey ☐ Black

CUSTOM PAINT OPTION:

- ☐ Base Coat/Clear Coat Automotive Paint
☐ Tri-Coat Paint

We go to work with you.

LEER Work Truck Solutions Since 1971

- ◆ The most recognized cap and tonneau brand in the industry since 1971
- ◆ Consistent functionality, craftsmanship and service
- ◆ Designed and engineered to perform in the toughest work environments
- ◆ DCC Aluminum and Fiberglass Commercial grade truck caps and tonneaus are available for virtually every truck on the road today
- ◆ LEER offers the best selection of options to customize your truck cap for any fleet or commercial application
- ◆ Three manufacturing and distribution locations: Pennsylvania, Indiana and California
- ◆ A strong network of 700 dealerships throughout the United States and Canada provide installation, service and warranty support

2. FRONT OPTIONS: Consider needed visibility, accessibility and security.



- ☐ Solid Front Wall (Standard)



- ☐ Front Radius Picture Window



- ☐ Front Radius Sliding Window



- ☐ DCC Front Rectangular Picture Window



- ☐ DCC Front Rectangular Sliding Window



- ☐ DCC Front Security Screen

3. HEIGHT OPTIONS: Important factors to consider when selecting the right height for your needs: headroom, accessibility and storage capacity.

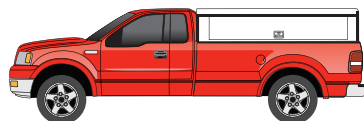

- ☐ 23" High – Compact (Standard)
☐ 23" High – Full Size (Standard)

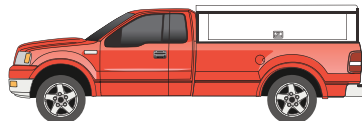

- ☐ 26" High Rise – Compact
☐ 26" High Rise – Full Size
☐ 26" Super Duty

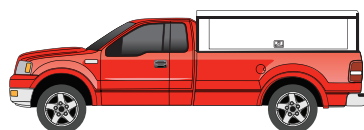

- ☐ 30" High Rise – Compact
☐ 30" High Rise – Full Size
☐ 30" Super Duty

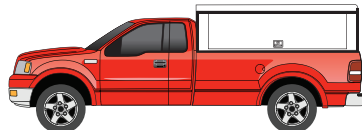

- ☐ 36" High Rise – Compact
☐ 36" High Rise – Full Size
☐ 36" Super Duty

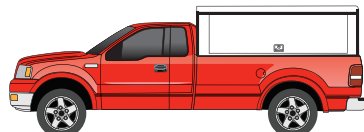

- ☐ 40" High Rise – Full Size
☐ 40" Super Duty

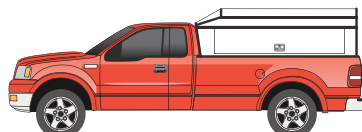

- ☐ 23" - 26" Wedge – Compact
☐ 23" - 26" Wedge – Full Size

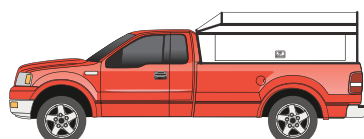

- ☐ 23" - 30" Wedge – Compact
☐ 23" - 30" Wedge – Full Size
☐ 26" - 30" Super Duty

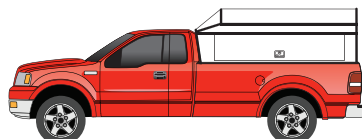

- ☐ 23" - 36" Wedge – Compact
☐ 23" - 36" Wedge – Full Size
☐ 26" - 36" Super Duty

4. REAR OPTIONS: Consider security, visibility and access requirements when selecting



- ☐ Solid Half Door (Standard)



- ☐ Half Door with Radius Picture Window



- ☐ Double Full Doors



- ☐ Rear Security Screen

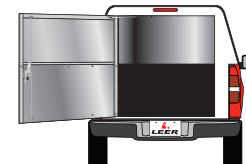

- ☐ Metal Skin Interior

Metal Skin Options

- ☐ Metal Skin Interior of Rear 1/2 door
☐ Metal Skin Full Interior Height of Rear Double Doors
☐ Metal Skin Full Interior Height of Single Full Door
☐ Metal Skin Full Interior Height Hatchback Door

5. SIDE OPTIONS: Choose from a variety of side options to customize your DCC.

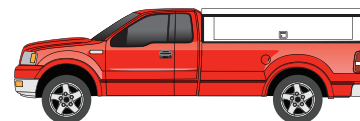

- Side Lift Door with Stainless Steel Drop T-Handle and Bolt Lock (Standard)
☐ Drivers Side ☐ Passengers Side

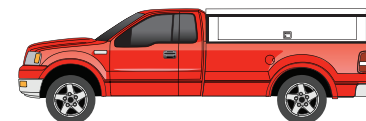

- Side Lift Door with Stainless Steel Drop T-Handle with Bolt Lock 66" for 8' Truck Beds (Optional)
☐ Drivers Side ☐ Passengers Side

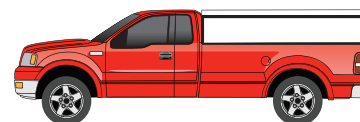

- ☐ Solid Sides (Delete Side Door)
☐ Drivers Side ☐ Passengers Side

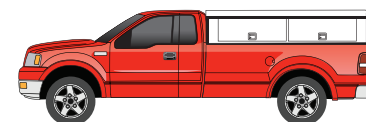

- 40" Double Side Doors (Long beds only)
☐ Drivers Side ☐ Passengers Side

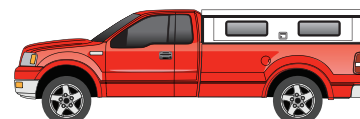

- Side Lift Door with Two Side Radius Windows
☐ Drivers Side ☐ Passengers Side

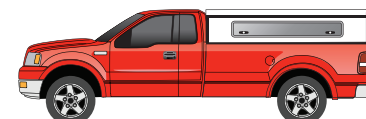

- Radius Side Window
☐ Drivers Side ☐ Passengers Side

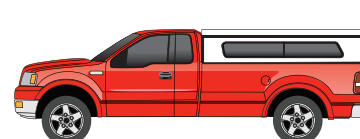

- Radius Side Sliding Window
☐ Drivers Side ☐ Passengers Side

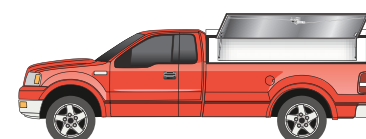

- Side Door Metal Skin Interior
☐ Drivers Side ☐ Passengers Side

rear options.

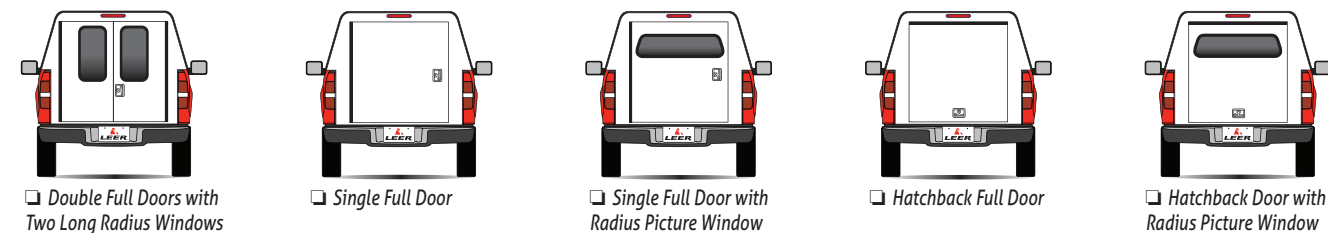

6. TOOL BOX SHELF AND DIVIDER OPTIONS: Please specify driver or passenger side for tool box configurations.

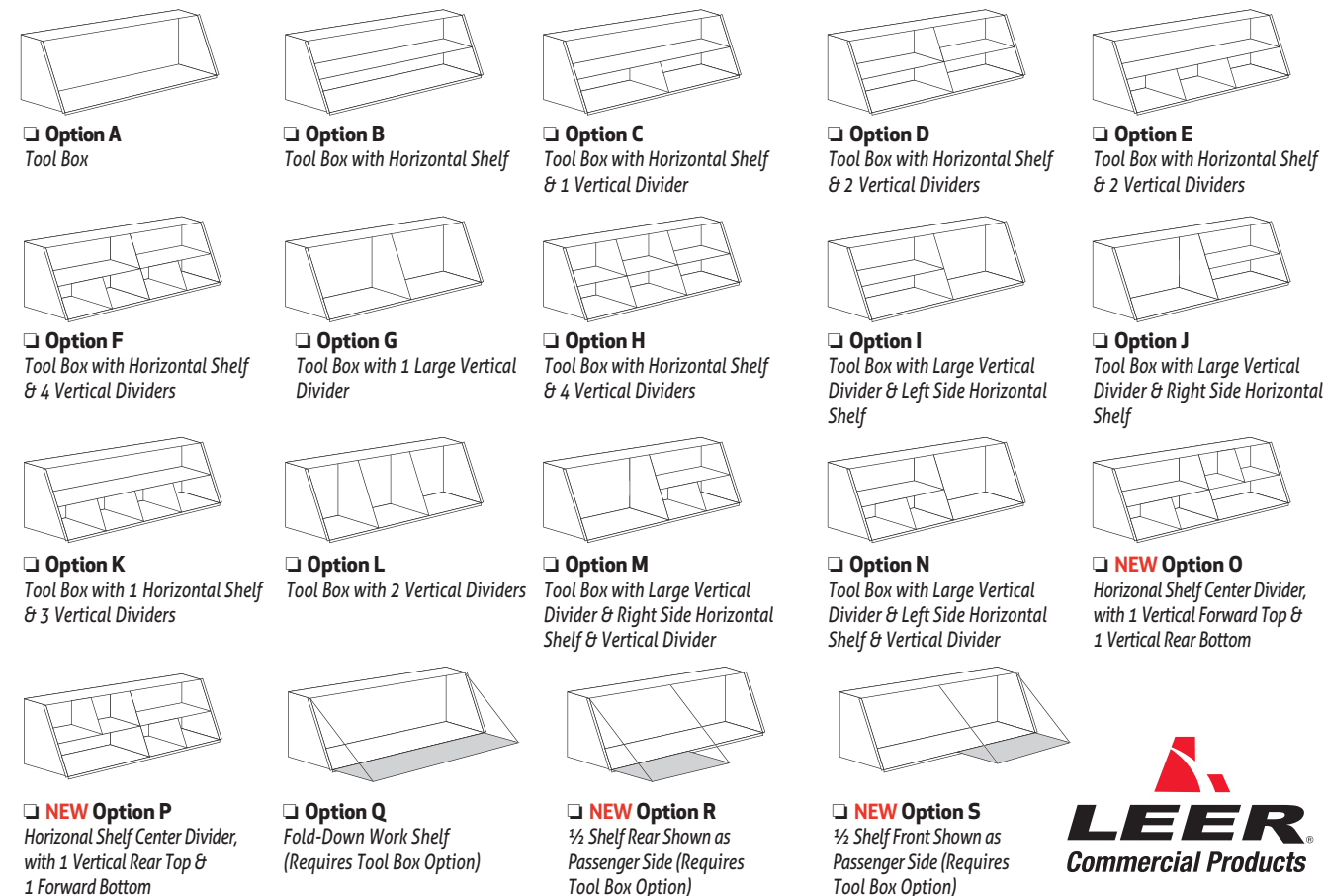

7. INTERIOR LIGHTING AND POWER OPTIONS: Select additional lights to improve visibility at night.



8. INTERIOR LED BAR LIGHT LOCATIONS:

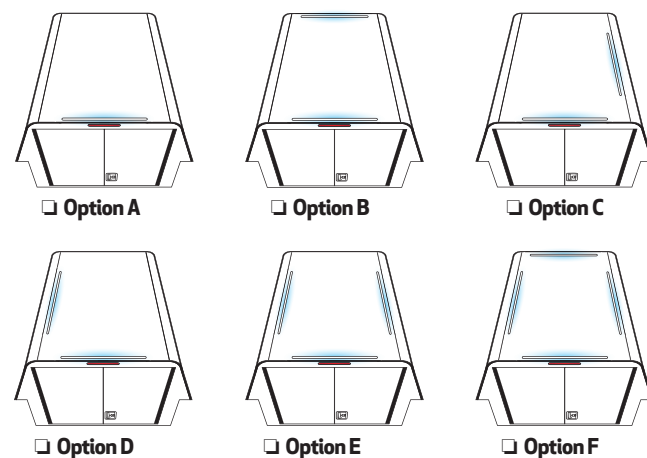

9. DCC RACK OPTIONS: Select the rack that fits your application.

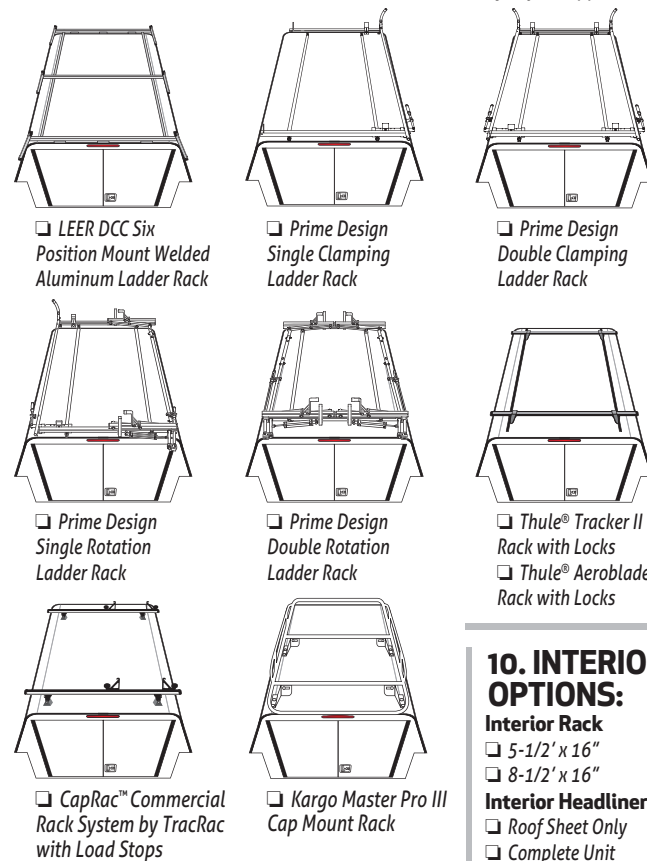

10. INTERIOR OPTIONS:

- Interior Rack**
- ☐ 5-1/2' x 16"
 - ☐ 8-1/2' x 16"
- Interior Headliner**
- ☐ Roof Sheet Only
 - ☐ Complete Unit (Side Doors Excluded)

ROAD
CLOSED

STOP

INDIANA AVE



100RCC

This sleek, good looking LEER cab-high cap provides a secure workshop while maintaining the automotive appeal of your truck.

BUILT WORKSITE TOUGH

100RCC & 180CC STANDARDS & OPTIONS

Standard Features:

- ◆ LEER Fiberglass Construction
- ◆ Interior Headliner
- ◆ Commercial Cap Structural Reinforcement
- ◆ Interior Dome Light
- ◆ Fiberglass Base Rails
- ◆ Recessed Third Brake Light
- ◆ Radius Fixed Front Window
- ◆ Dupont Automotive Paint
- ◆ Solid Sides (No doors or windows)
- ◆ Limited 5 Year Color and Structure Warranty
- ◆ Recessed Dark Tint Rear Door with Double T-Handles

Automotive Paint Option:

- ◆ Tri-Coat Paint

Front Options:

- ◆ Radius Fixed Front Window – Standard
- ◆ Radius Front Sliding Window

Side Door Options:

- ◆ Solid Sides (No doors or windows) – Standard
- ◆ 50/50 Radius Side Sliding Window with Screen
- ◆ Radius Side Window (Dark tint glass)
- ◆ Fiberglass Painted Access Door

100RCC



100RCC





180CC

Tool Box Options:

- ◆ Tool Box - Shortbed
16" high x 12" deep (*Shelves and dividers are available*)
- ◆ Tool Box - Longbed
16" high x 12" deep (*Shelves and dividers are available*)
- ◆ Tool Box Headliner
- ◆ Rubberized Non-Slip Mat for Toolbox Floor
- ◆ Storage Solutions – Parts Bins and Shelf Units

Interior Options:

- ◆ Additional Interior Dome Light (*Battery or 12V*)
- ◆ 12V Automatic Dome Light Switch (*Requires 12V Dome Light order*)
- ◆ 12V Three-Outlet Power Block

Rear Door Options:

- ◆ Recessed Dark Tint Rear Door with Screen – Standard
- ◆ Solid Rear Door with Color Matched Aluminum Insert
- ◆ Solid Rear Door with Color Matched Fiberglass Insert, Drop T-Handle

Tool Box Shelf and Divider Options

- (*Requires painted access door*)
- ◆ Includes Metal Tool Box, Shelf, or Divider (*See chart*)

Exterior Rack Options:

- ◆ Thule Aeroblade Roof Rack System with Locks
- ◆ Thule Tracker II Roof Rack System with Locks
- ◆ Thule Tracker II (*Load Stops, Load Straps, Quickdraw*)
- ◆ CapRac - Commercial Rack System (*2 - Bar Set with Load Stops*)
- ◆ **NEW** Prime Design Single Clamping Ladder Rack – 6' Option
- ◆ **NEW** Prime Design Single Clamping Ladder Rack – 8' Option
- ◆ **NEW** Prime Design Double Clamping Ladder Rack – 6' Option
- ◆ **NEW** Prime Design Double Clamping Ladder Rack – 8' Option
- ◆ **NEW** Prime Design Single Clamp and Rotation Ladder Rack – 6' Option
- ◆ **NEW** Prime Design Single Clamp and Rotation Ladder Rack – 8' Option
- ◆ **NEW** Prime Design Double Rotation Ladder Rack – 6' Option
- ◆ **NEW** Prime Design Double Rotation Ladder Rack – 8' Option
- ◆ **NEW** Prime Design Ladder Bar (*For step ladders shorter than crossbar spacing*)
- ◆ **NEW** Beacon Light Mounting Bracket (GO) (*Front of rack mount*)
- ◆ **NEW** Beacon Light Mounting Bracket (Strobe) (*Rear of rack mount*)



180CC

This LEER commercial cap is reinforced for commercial roof racks, offers optional fiberglass side doors, tool box options and more.



180CC

Optional Painted Side Access Door

100RCC & 180CC ORDER FORM

Truck Year _____ Truck Brand _____

Truck Model _____

Cab Style ☐ Reg Cab ☐ Ext Cab
☐ Quad Cab – 4 Door ☐ Double Cab

Box Style ☐ Long Box ☐ Short Box
☐ Extra Short ☐ Flareside/Sportside/Stepside

Truck VIN _____

Truck Color Code _____

1. TRI-COAT PAINT:

☐ Base Coat/Clear Coat Automotive Paint

2. FRONT OPTIONS:

Consider needed visibility, accessibility and security.



☐ Front Radius Picture Window (Standard)



☐ Front Radius Sliding Window



Stainless Steel Drop T-handle



Optional Painted Access Door with Tool Box



Optional Tool Box with Storage Bin



Optional Three Shelf Storage Unit

3. 100RCC REAR OPTIONS: Consider security, visibility and access requirements.



☐ 100RCC Recessed Dark Tint Rear Door with Double T-Handles (Standard)



☐ 100RCC Solid Rear Door with Color Matched Aluminum Insert & Double T-Handles

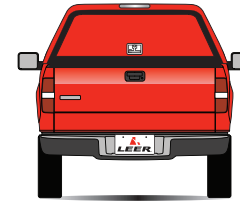

☐ 100RCC Solid Rear Door with Color Matched Fiberglass Insert & Stainless Steel Drop T-Handle

3. 180CC REAR OPTIONS: Consider security, visibility and access requirements.



☐ 180CC Recessed Dark Tint Rear Door with Double T-Handles (Standard)



☐ 180CC Solid Rear Door with Color Matched Aluminum Insert & Double T-Handles



☐ 180CC Solid Rear Door with Color Matched Fiberglass Insert & Stainless Steel Drop T-Handle

5. TOOL BOX SHELF AND DIVIDER OPTIONS: Please specify driver or passenger side for tool box configurations.

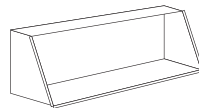

☐ Option A Tool Box

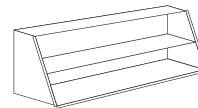

☐ Option B Tool Box with Horizontal Shelf

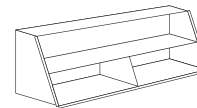

☐ Option C Tool Box with Horizontal Shelf & 1 Vertical Divider

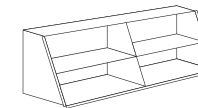

☐ Option D Tool Box with Horizontal Shelf & 2 Vertical Dividers

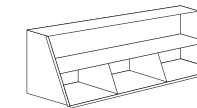

☐ Option E Tool Box with Horizontal Shelf & 2 Vertical Dividers

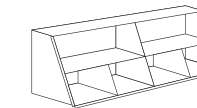

☐ Option F Tool Box with Horizontal Shelf & 4 Vertical Dividers

6. INTERIOR LIGHTING AND POWER OPTIONS:

Select additional lights to improve visibility at night.



☐ 12V Three Outlet Power Block



☐ 180CC Third Brake Light (Standard)



☐ 100RCC & 180CC Interior 12V Dome Light



☐ 100RCC Third Brake Light (Standard)



☐ Battery Dome Light

☐ 12V LED Automatic Gas Prop Switch



7. LIGHTING CONFIGURATIONS:

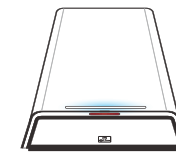

☐ Option A

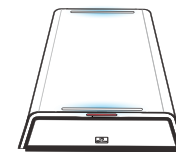

☐ Option B



☐ Option C

4. 100RCC SIDE OPTIONS:

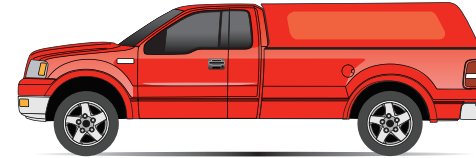

Solid Sides No Windows (Standard) (Sides will show recess)

☐ Drivers Side ☐ Passengers Side

4. 180CC SIDE OPTIONS:

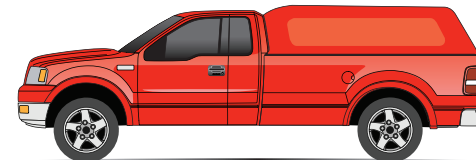

Solid Sides No Windows (Standard) (Sides will show recess)

☐ Drivers Side ☐ Passengers Side

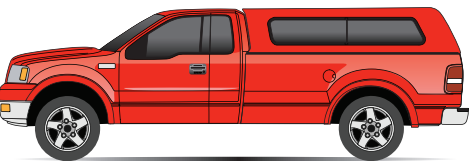

50/50 Side Slider Window with Screen
☐ Drivers Side ☐ Passengers Side

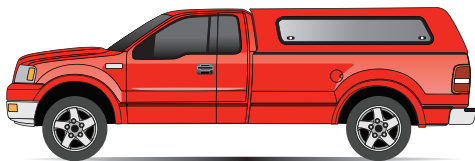

Radius Side Window
 (Window N/A with tool boxes)
☐ Drivers Side ☐ Passengers Side

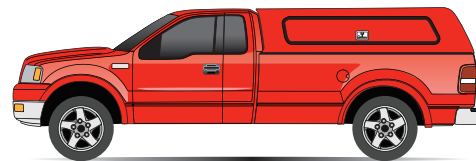

Radius Side Painted Access Door with Stainless
 Steel Drop T-Handle
☐ Drivers Side ☐ Passengers Side

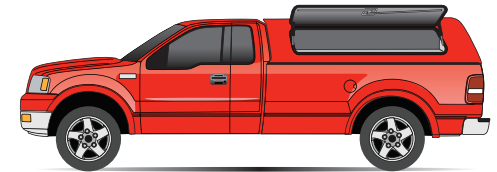

Radius Side Painted Access Door with Tool Box
☐ Drivers Side ☐ Passengers Side

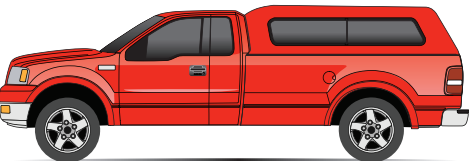

50/50 Side Slider Window with Screen
☐ Drivers Side ☐ Passengers Side

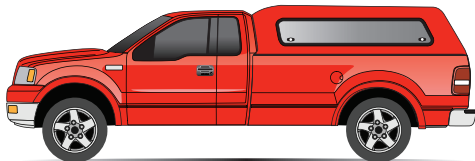

Radius Side Window (Window N/A with tool boxes)
☐ Drivers Side ☐ Passengers Side

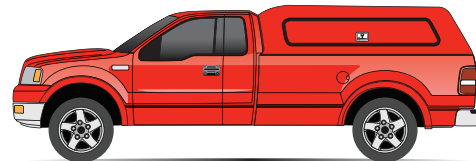

Radius Side Painted Access Door with Stainless
 Steel Drop T-Handle
☐ Drivers Side ☐ Passengers Side

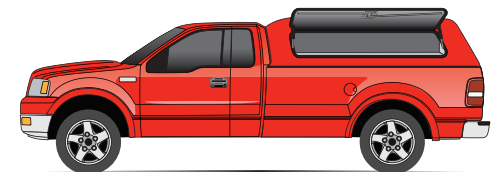

Radius Side Painted Access Door with Tool Box
☐ Drivers Side ☐ Passengers Side

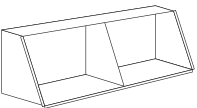

☐ **Option G**
 Tool Box with 1 Large
 Vertical Divider

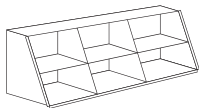

☐ **Option H**
 Tool Box with
 Horizontal Shelf &
 4 Vertical Dividers

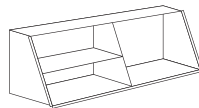

☐ **Option I**
 Tool Box with Large
 Vertical Divider & Left
 Side Horizontal Shelf

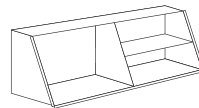

☐ **Option J**
 Tool Box with Large
 Vertical Divider & Right
 Side Horizontal Shelf

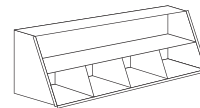

☐ **Option K**
 Tool Box with 1
 Horizontal Shelf &
 3 Vertical Dividers

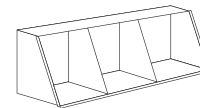

☐ **Option L**
 Tool Box with 2
 Vertical Dividers

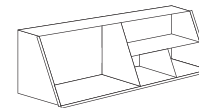

☐ **Option M**
 Tool Box with Large
 Vertical Divider &
 Right Side Horizontal
 Shelf & Vertical Divider

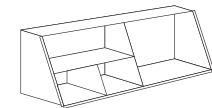

☐ **Option N**
 Tool Box with Large
 Vertical Divider &
 Left Side Horizontal
 Shelf & Vertical Divider

**Interior
 Rack**
☐ 5-1/2' x 16"
☐ 8-1/2' x 16"
☐ **Interior
 Headliner**



☐ **Option D**



☐ **Option E**



☐ **Option F**



☐ **Thule® Aero Blade
 Rack with Locks
 (100RCC and 180CC
 only)**



☐ **Thule® Tracker II
 Rack with Locks
 (100RCC and 180CC
 only)**

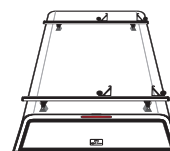

☐ **CapRac™
 Commercial Rack
 System by TracRac**



☐ **Prime Design
 Single Clamping
 Ladder Rack**

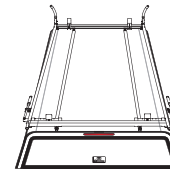

☐ **Prime Design
 Double Clamping
 Ladder Rack**

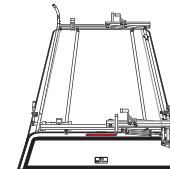

☐ **Prime Design
 Single Rotation
 Ladder Rack**

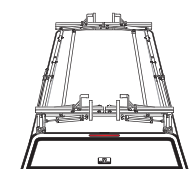

☐ **Prime Design
 Double Rotation
 Ladder Rack**

8. FIBERGLASS RACK OPTIONS: Select the rack that fits your application.



Prime Design single horizontal rotation ErgoRack™



Operates safely from the rear of the vehicle



Easy ergonomic operation



*Prime Design
locking ladder rack
with step ladder option*

EASY DOES IT

The ErgoRack™ by Prime Design is designed to minimize the physical stresses involved in loading and unloading heavy, bulky ladders. The single horizontal rotation positions ladders for easy access. ErgoRack™ reduces lower back and shoulder stress by eliminating the need to step on the bumper or tailgate to access a ladder. The lightweight design is lighter than steel ladder rack solutions for improved gas mileage and savings. Lockable security feature reduces theft at the job site and on the road.

LEER
Commercial Products



www.leerfleet.com

The information on this sheet may have been updated since printing and LEER truck caps and tonneaus may not be available for all import and domestic trucks. The equipment shown or described here may have regional plant manufacturing differences and may only be available as factory-installed options at an additional cost. Check with your local LEER Dealer for complete product information. LEER reserves the right to make changes in prices, colors, materials, equipment, specifications, and models at any time without notice or prior obligation.
©2014 LEER®, A Member Company of TAG Truck Accessories Group, LLC. 5/14 - Form #132161

A Member Company of  TAG Truck Accessories Group, LLC

Authorized LEER Dealer